

Bearing & distance up Lehi —
are 1 5 82 W 94
2 N 87 W 29 1/2
123 1/2

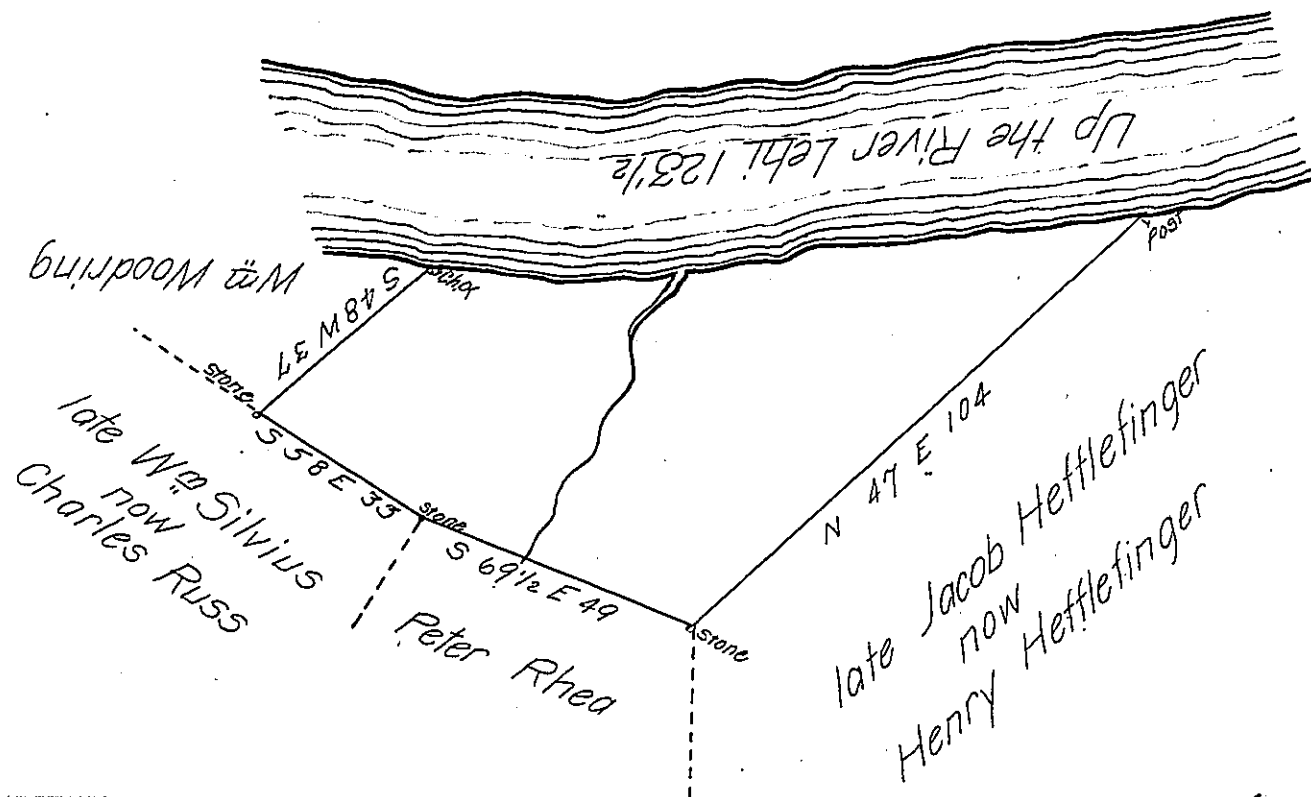

By Virtue of a Warrant dated the 29-August 1753 Resurveyed the 24-December 1789 to Jacob Hefflefinger the above described tract of land Situate in Whitehall and Heidleberg Townships Northampton County Containing thirty Acres ninety three perches and the Allowance of Six P Cent

P. Geo. Palmer

Daniel Brodhead Esq. }
Survey General }

IN TESTIMONY that the above is a copy of the original remaining on file in the Department of Internal Affairs of Pennsylvania, made conformably to an Act of Assembly approved the 16th day of February, 1833, I have hereunto set my Hand and caused the Seal of said Department to be affixed at Harrisburg, this thirtieth day of January 1905

Joseph P. Brown
Secretary of Internal Affairs.